

## Pole Terminal WBT-0702

The perfect high-current pole terminal

WBT

### WBT-0702 E

- ☐ Signature platinum  
☐ Signature gold  
☐ Standard gold



## Pole Terminal WBT-0702

The perfect high-current pole terminal

Made in Germany

for cables of 1.5 - 16.0 mm<sup>2</sup>

Design Patent

A precise functionality of the best measuring instruments can only be achieved if the necessary contacting components are of the equivalent state-of-the-art. The pole terminal WBT-0702 offers the best qualifications hereto through its ingenious mechanics.

**WBT-0702 is available in 3 versions:**

- WBT-0702.01** Standard gold  
**WBT-0702.11** Signature gold  
**WBT-0702.12** Signature platinum

All three models guarantee an optimum contact quality and security. Moreover, the surface of the Signature terminals is highly compressed which enables a direct surface refinement with gold respectively platinum. Thanks to this the WBT Signature products feature clearly decreased transition resistance, high conduction of current and excellent corrosion resistance.

### Termination options

WBT-0702 not only accepts 4-mm banana plugs without difficulty but clamps it reliably thanks to the integrated collet chucking device (WBT Patent). The collet chucking device operates by turning the front knurled lock nut which is activated this way and so a perfect protection against unwanted loosening of the banana connection is secured. Before inserting of the banana plug the lock nut must always be loosened.

*Sandwich Spades and crimped cable ends* (up to 16 mm<sup>2</sup>) are clamped effectively through the second nut. The milled grooves in the compression pad and plate of the base element of the terminal provide more intensive clamping of the sandwich spades or cables and prevent them from sliding away while clamping.



### Internal termination

WBT-0702 adopts cables up to 10 mm<sup>2</sup>. Recommended cable connection: crimp technique. Cable ends can be perfectly fastened by the means of Torx screw and Torx T.6 screwdriver supplied with the pole terminal. If soldering is chosen, WBT recommends application of the silver solder WBT-0800 which is gentle on precious metal surfaces.

### Build-in instructions

The pole terminals WBT-0702 are suitable for mounting on measuring and gain control amplifier as well as transducer with wall thickness up to 10 mm. The suggested minimum distance is 30 mm (compare drilling scheme). At the distance of 30 mm the black puzzle plates can be clipped together. This new WBT build-in conception protects your WBT-0702 reliably from rotation. For mounting in solid cabinets the Mounting kit WBT-0716 is recommendable. For its application a blind hole in the chassis is necessary.

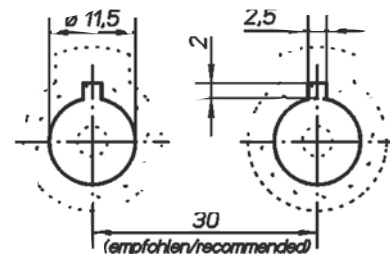

### Build-in dimensions:

- drill hole  $\varnothing$  11.5 mm for pole terminal, with 2.5 x 2 mm nut for twist protection
- minimum distance between the terminals' centers: 30 mm
- part which stands out of panel: 32 mm

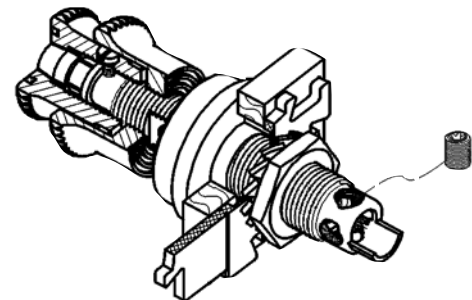

### Operating features:

- constant current:  $I_D > 400$  A
- peak current:  $I_S > 2,000$  A
- contact resistance:  $R_U \leq 0.1$  mohms (Signature:  $R_U \leq 0.07$  mohms)

**Instructions:** The pole terminal WBT-0702 is only permitted for low voltage application. Before disconnecting of banana plug the lock nut of the terminals must always be loosened.

Detailed product information available.

Design and specifications subject to change without notice.

© WBT-Distribution GmbH · Im Teelbruch 103 · 45219 Essen · Germany

Tel.: +49 (0) 2054 87 552-0 · Fax: +49 (0) 2054 87 552-22

e-mail: info@wbt.de · Internet: www.wbt.de